

\\lbbes02\proj\ca\2005\05070-05079\05072_SW_multipurpose\Drawings\Working Drawings\Current\WD_SWGR_Edm\Shets\SOU136(MN)-05-A2-1.dwg Plotted on: January 22, 2009 - 2:29 PM

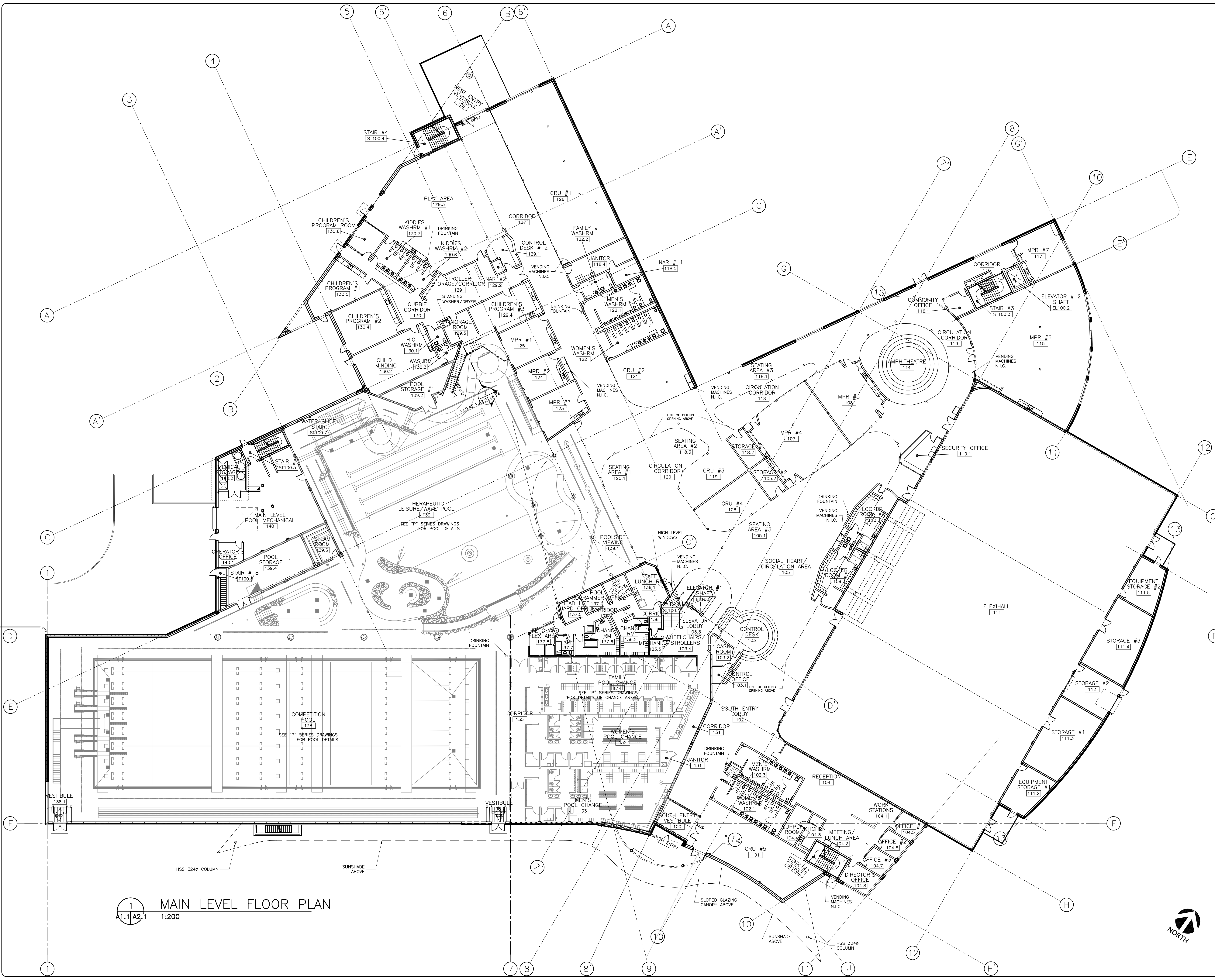

1 MAIN LEVEL FLOOR PLAN
A1.1/A2.1 1:200

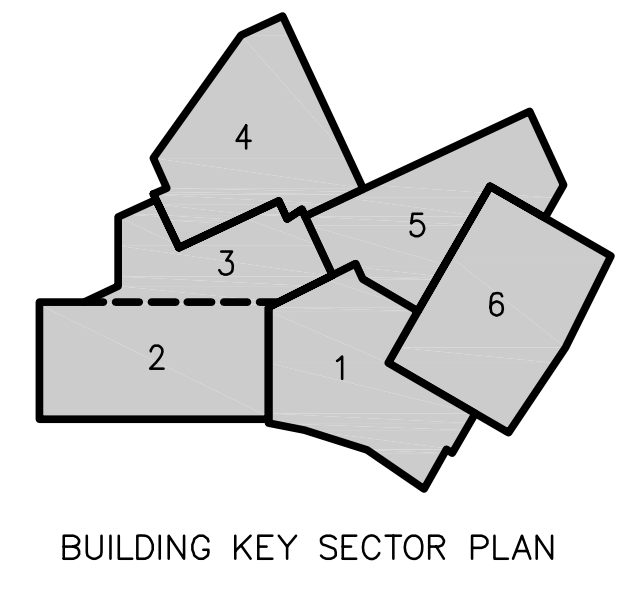

no.	description	revisions	date	checked
1	MISCELLANEOUS REVISIONS, UPDATES		JAN 19, 2008	JT
2	BASEMENT/INTERGRATION REVISIONS		OCT 10, 2008	JT

ISSUE	DATE
ISSUED FOR DESIGN DEVELOPMENT REPORT	MAY 30, 2007
ISSUED FOR DEVELOPMENT PERMIT	AUG. 8, 2007
ISSUED FOR 75% REVIEW	OCT 15, 2007
ISSUED FOR 95% REVIEW	DEC. 21, 2007
ISSUED FOR BUILDING PERMIT	MAY 14, 2008
ISSUED FOR CON # 11	NOV. 18, 2008

seal

permit

consultants

consultant project no. 05072



project
SOUTHWEST COMMUNITY RECREATION CENTRE
EDMONTON, ALBERTA
location: 15204-23 AVENUE NW

drawing title
MAIN LEVEL KEY PLAN

scale 1:200 all dimensions are in millimeters

drawn by JT, AK08, PG
date MAY 30, 2007

checked by JT
date MAY 13, 2008

reviewed by
date

CAD file name: SOU136(MN)-05-A2-1

drawing no. **A2.1**
sheet no. 11 of 143
project no. 21-05-7372